



MASTERPIECES  
MADE IN GERMANY

## Flow Monitor & Flow Indicator

# DKG-2



## OVERVIEW

### Operation

- Float measuring principle

### Application

- Mechanical engineering
- Central lubrication
- Circulation lubrication
- Transformers

### Features

- Universal orientation
- High reliability
- Viscosity compensated
- Infinitely variable switch point adjustment by operator
- EX-version according to ATEX directive available
- Scales are burned onto the sight glass
- Threaded connection, special thread on request

### Installation information

- The operating instructions for DKG-2 Module BASICS / ...ATEX must be observed!
- **Download: [www.meister-flow.com](http://www.meister-flow.com)**

## OPERATING DATA

<b>Operating pressure, max.</b>	16 bar
<b>Pressure drop</b>	0,02 – 0,2 bar
<b>Viscosity range</b>	30 cSt to 600 cSt
<b>Temperature, max.</b>	120 °C (optional 160 °C)
<b>Measuring accuracy</b>	±10 % of full scale

Changed operating data apply to the devices in explosion-proof design according to ATEX directive. Refer to the Operating Instructions for DKG-2 Module ATEX.

Download: [www.meister-flow.com](http://www.meister-flow.com)

## MEASURING RANGES

Type	Switch range for Oil, density 0,9 kg/dm <sup>3</sup> <sup>(1)</sup>		
	l/min	gph	gpm
DKG-2/2	0,5 – 1,7	8 – 27	
DKG-2/3	0,8 – 2,5	13 – 40	
DKG-2/4	1,3 – 4	21 – 63	
DKG-2/8	2,5 – 8	40 – 127	

<sup>(1)</sup> The specified measuring- /switch ranges are valid for oils having a density of 0.9 kg/dm<sup>3</sup> and a kinematic viscosity of 30 to 600 cSt, vertical installation of the device and flow direction from bottom to top.

Other installation positions or deviation from the operating densities and operating viscosities will increase the measurement error specified in the data sheet. Excessive operating viscosities will influence or may prevent function of the device.

Upon request, special scales for deviating media, different operating conditions and installation positions (only for devices which can be installed in any position) are available.

The specified switch values are switch-off points, i.e. switch values by decreasing flow.

Other measuring- /switch ranges are available upon request.

## MATERIALS

### Brass version, wetted parts

Spring:	1.4571
Sight glass:	DURAN® 50
Gaskets:	FKM (optional NBR, EPDM) <sup>(2)</sup>
Magnets:	Hard ferrite
all other wetted parts:	Brass, nickel-plated

### Brass version, non-wetted parts

Device housing:	Aluminium, anodized
-----------------	---------------------

### Stainless steel version, wetted parts

Spring:	1.4571
Sight glass:	DURAN® 50
Gaskets:	FKM (optional NBR, EPDM) <sup>(2)</sup>
Magnets:	Hard ferrite
all other wetted parts:	1.4571

### Stainless steel version, non-wetted parts

Device housing:	Aluminium, anodized
-----------------	---------------------

<sup>(2)</sup> Other gasket materials on request



Proudly Distributed By

**TRIDENT** AUSTRALIA  
FLUID SYSTEMS & COMPONENTS

## TECHNICAL DRAWING

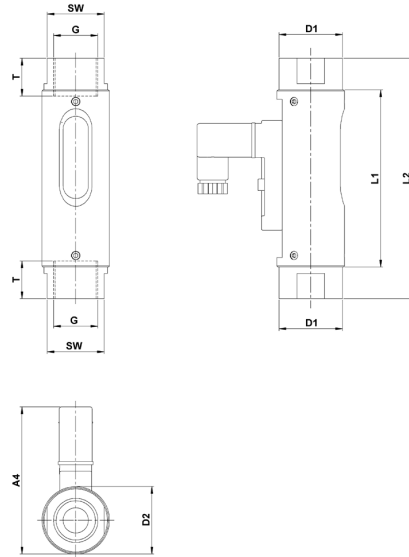

## SUMMARY OF TYPES

Type	Overall dimensions [mm]												Weight approx. [g]
	G	DN	SW	L1	L2	T	D1	D2	A1	A2	A3	A4	
DKG-2/2													
DKG-2/3	1/2"	15	27	84	114	14	30	32	-	-	-	~70	300
DKG-2/4													
DKG-2/8													

DKG-2 3 0001 12-15 E M

## ELECTRICAL DATA

### For devices with switch contact 15x50

<b>Change over (COC)</b>	250V · 1,5A · 50VA <sup>(3)</sup>
<b>Normally open (NOC)</b>	230V · 3A · 60VA
<b>Change over M12x1 (-20 °C – 85 °C)</b>	125V · 1,5A · 50VA <sup>(3)</sup>
<b>Normally open M12x1 (-20 °C – 85 °C)</b>	125V · 3A · 60VA
<b>Change over PLC</b>	250V · 1A · 60VA

### EX-version in compliance with ATEX directive

#### EC-Type examination

EPS 13 ATEX 1 596 U

### Connection to certified intrinsically safe circuits

Li = 0 Ci = 0

Gas			Dust		
Ui	Ii	Pi	Ui	Ii	Pi
< 12,1 V	1,0 A	3,0 W	< 12,1 V	0,25 A	0,75 W
< 20 V	0,309 A	1,55 W	< 20 V	0,25 A	0,75 W
< 25 V	0,158 A	0,99 W	< 25 V	0,25 A	0,75 W
< 30 V	0,101 A	0,76 W	< 30 V	0,25 A	0,75 W

### Operating temperature

-5 °C < T<sub>Service</sub> < 45 °C

<sup>(3)</sup> Minimum load 3VA

### Marking

Ⓔ II 2G Ex ib IIC  
Ⓔ II 2D Ex ib IIIC

## ELECTRICAL CONNECTION

### For devices with switch contact 15x50

- Connector in compliance with EN 175301-803, Form C (DIN 43650, Form C)
- Connector M12x1
- Cable (1 m) <sup>(4)</sup>

### EX-version in compliance with ATEX directive

- Connector in compliance with EN 175301-803, Form C (DIN 43650, Form C)
- Connector M12x1
- Cable (1 m) <sup>(4)</sup>

### Ingress Protection

IP65: Connector in compliance with EN 175301-803, Form C or Connector M12x1  
IP67: Cable

### Output signal

The contact opens / changes when the flow decreases below the set point.

### Power supply

Not required (potential-free reed contacts)

### Connector types

Other connector types or cable lengths on request

<sup>(4)</sup> Available as Normally Open Contact (NOC) only

## CONNECTION DIAGRAM

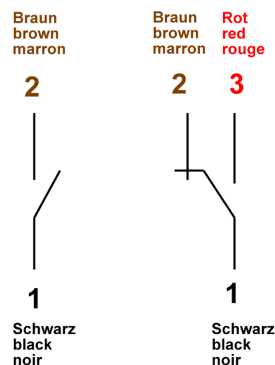

DKG-2 4 0002 10-17 E.M

Meister Strömungstechnik GmbH • Im Gewerbegebiet 2 • 63831 Wiesen / Germany  
Tel. +49 (0) 6096 9720-0 • Fax +49 (0) 6096 9720-30 • sales@meister-flow.com • www.meister-flow.com  
The general business terms of Meister Strömungstechnik GmbH are valid • All rights reserved

